

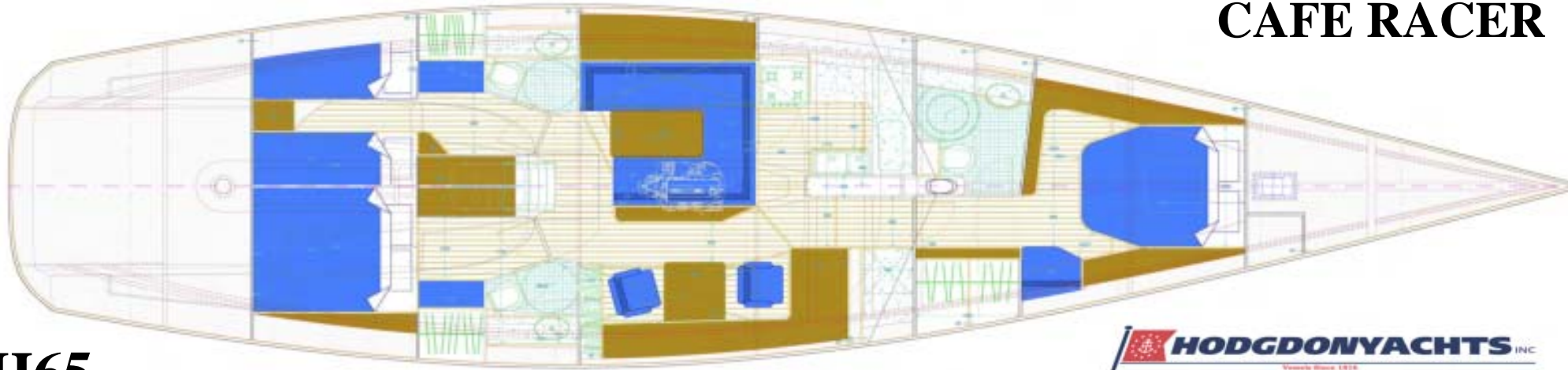

 **HODGDON YACHTS**

TRIPP DESIGN
naval architecture 

CAFÉ RACER



H65

PRINCIPAL DIMENSIONS

LOA	19.74m	64.9'
LWL	18.29m	60.0'
Beam	4.81m	15.9'
Displacement (1/2 load)	23 tonnes	25.7 tons
Draft	2.38m Keel raised	7.10'
	3.77m Keel lowered	12.4'

TANK CAPACITY

Fuel	1000 L	264 gal
Freshwater	850 L	225 gal

EQUIPMENT

Spars	Hall Carbon fiber mast w/ 3 swept back spreaders Hall wing shaped boom Harken batt-car system
Hydraulic Winches	Harken/Navtec Harken
Sails	North 3DL
Electrical	24vDC electrical Service bus 600 amp hour capacity Radio bus – 200 amp hour capacity 120 – 240 vAC Electrical distribution system Generator - MasterVolt 12kW Generator

ARRANGEMENT

Three cabins with ensuite heads, galley and settee down, raised pilot-house contains a wrap around settee and interior navigation and steering station, large cockpit with twin helms and a swim platform.

DRIVE LINE

Volvo D3 110 Turbo diesel with 2.48 reduction gear turning a Gori 3-blade folding propeller with 24v 140 amp alternator

SAIL PLAN

I=26m, J=6.95m, P=24.95m, E=8.57m, STL= 9.1m (sprit)

Upwind Sail Area	198 sqm	2,132 sq.ft.
Downwind Sail Area	460 sqm	4,951 sq.ft.

